

G57JAS01XX Series Inox

12" Center on center stainless steel grab bar with concealed flange plates. 1.25" diameter, 1.2mm wall thickness, 304 stainless steel.

Mounting hardware supplied for wood stud installation.

Product Data

| | |
|----------------------------|----------------------|
| Overall Dimensions (Inch.) | 15-1/16x2-3/4x3-1/16 |
| Net Weight (lbs.) | 1.01 |

Installation Hardware Details

Stainless steel screw and dowels

Packaging Details

| | |
|------------------------------|--------------------------|
| Package | Polyethylene package |
| Package dimensions (Inch.) | 15-1/8 x 2-13/16 x 3-1/8 |
| Weight with Packaging (lbs.) | 1.01 |

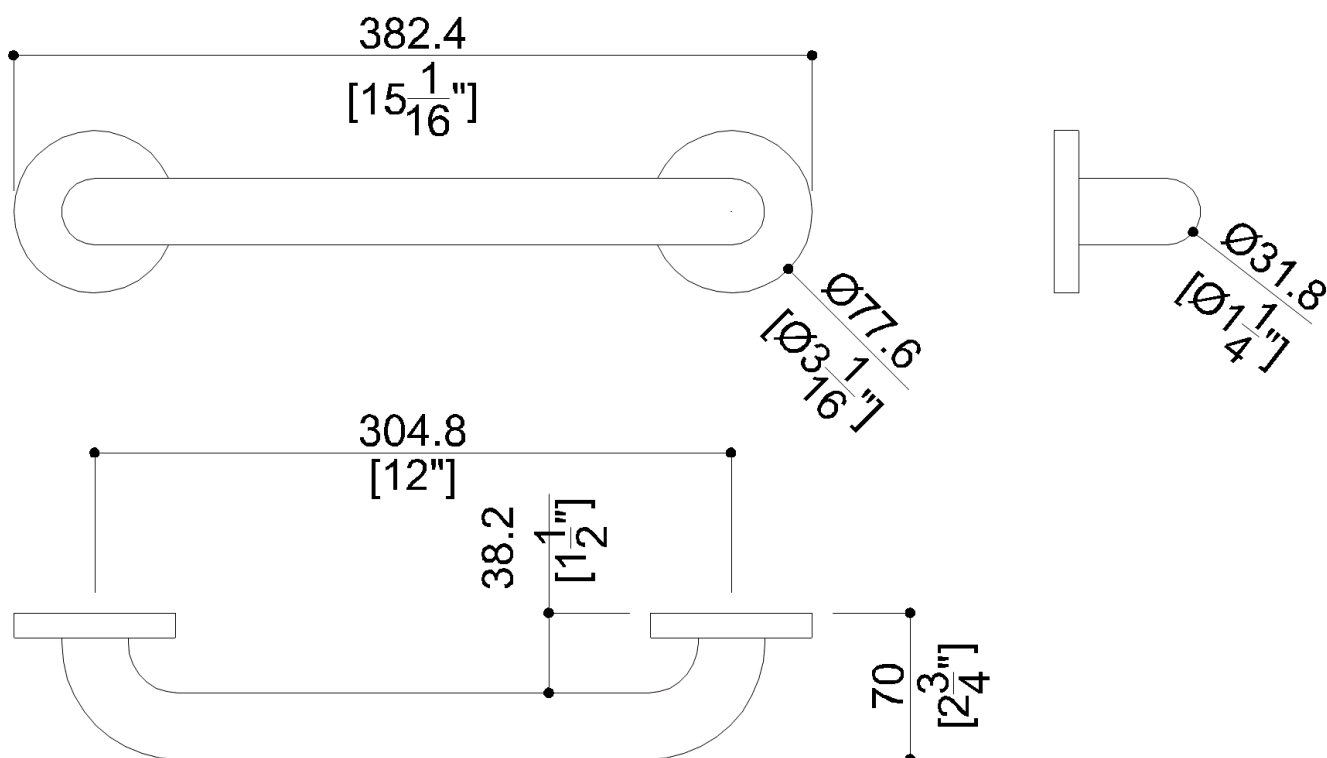

G57JAS01XX Series Inox

AISI304 stainless steel fixing plate

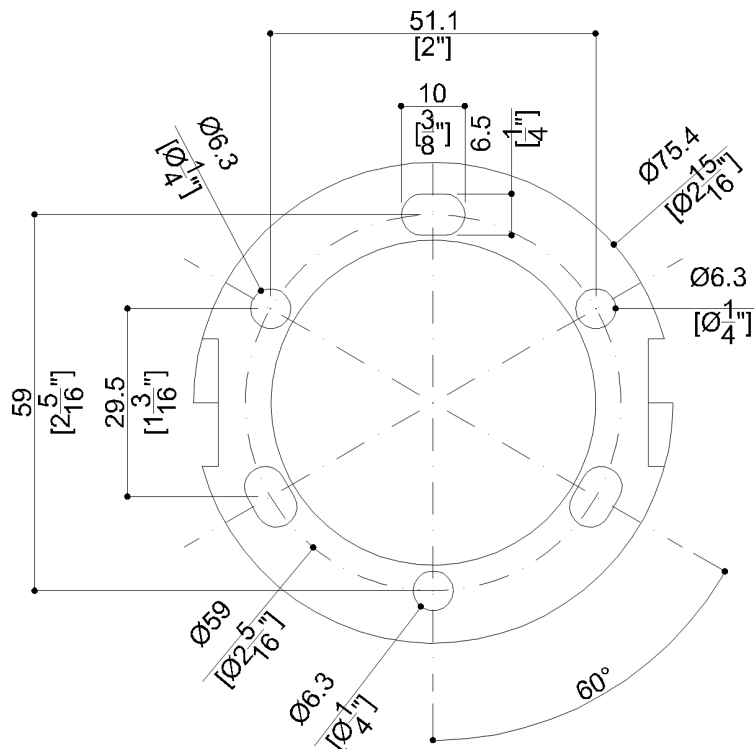

Available Finishes (xx)

| | | |
|-------------|-------|--------|
| DM | N1 | N2 |
| Black Matte | Satin | Bright |

Load Capacity

| | |
|----------|----------|
| Vertical | 450 lbs. |
|----------|----------|

Warning

Before installation and use, read the installation and use instructions in their entirety. If questions arise please contact Ponte Giulio company.

Cleaning

The device is not affected by the room's temperature, though it must NOT be installed in environments subject to temperatures below 4°C or above 40°C.
Do not install in saunas. Not comply with the indicated temperatures may damage the plastic coating of the device.

Warranty

Please visit www.pontegiulio.com for complete warranty details.

Materials and finishes

| | |
|-----------------|------|
| Stainless Steel | N/A. |
|-----------------|------|