

G56UGS01XX *Series* Stainless Steel

Stainless steel, folding and locking grab bar. 1.25" diameter, 1.2mm wall thickness, 304 stainless steel.

Mounting hardware supplied for wood stud installation.

Product Data

Overall Dimensions (Inch.)	17-1/2 x 12 x 3-15/16
Net Weight (lbs.)	4.08

Installation Hardware Details

Stainless steel screw and dowels	Fischer SX 8 6x70 Inox
----------------------------------	------------------------

Packaging Details

Package	LDPE bag in cardboard box
Package dimensions (Inch.)	16-7/8 x 4-5/16 x 17-1/8
Weight with Packaging (lbs.)	5.07

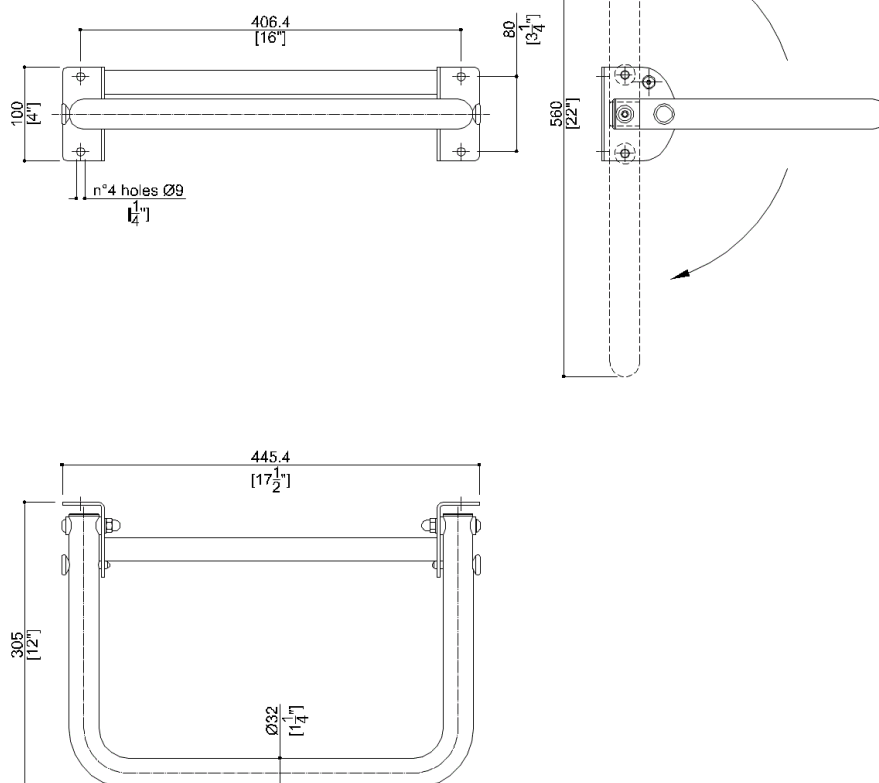

G56UGS01XX *Series* Stainless Steel

Available Finishes (xx)

N1
 Satin

Materials and finishes

Stainless Steel Satin

Load Capacity

Vertical	250 lbs.	Horizontal	450 lbs.
----------	----------	------------	----------

Warning

Before installation and use, read the installation and use instructions in their entirety. If questions arise please contact Ponte Giulio company.

Cleaning

- The grab bar is not affected by the room's temperature, though it must not be installed in locations subject to temperatures below 39°F (4°C) or above 104°F (40°C).
- Do not install in saunas.
- Not following the temperature recommendations may result in damage to vinyl coating on grab bars and flange.

Warranty

Please visit www.pontegiulio.com for complete warranty details.