

## G41JCS09XX Series Tubocolor

23" Antimicrobial vinyl coated folding grab bar. No pinch flange and follows commercial child safety protocol. No maintenance 3mm thick antimicrobial vinyl coating. Stainless steel mounting plate concealed by ABS flange cover.

Mounting hardware not supplied.

### Product Data

Overall Dimensions (Inch.)	4-7/16x23-5/8x9-3/16
Net Weight (lbs.)	6.45

### Installation Hardware Details

### Packaging Details

Package	LDPE bag in cardboard box
Package dimensions (Inch.)	5-1/8 x 24-13/16 x 8-11/16
Weight with Packaging (lbs.)	7.33

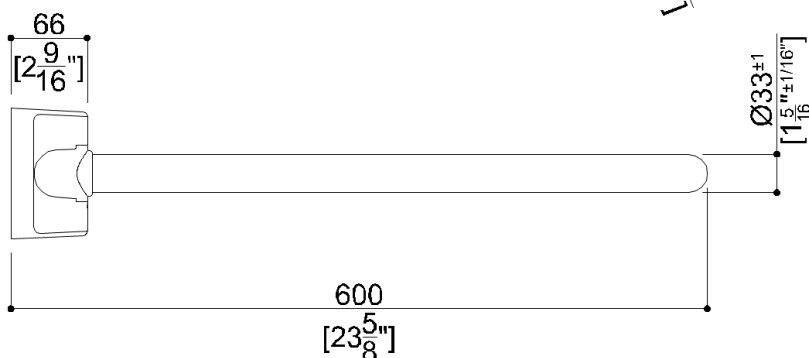
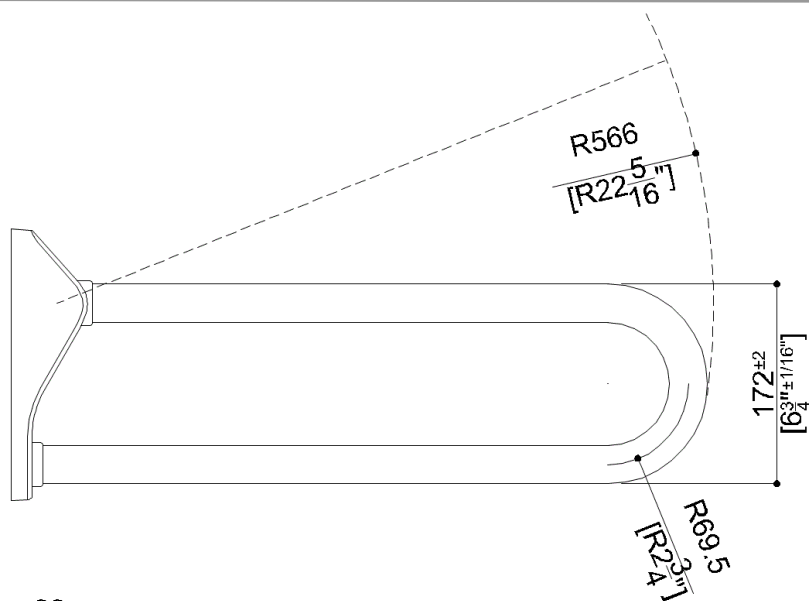
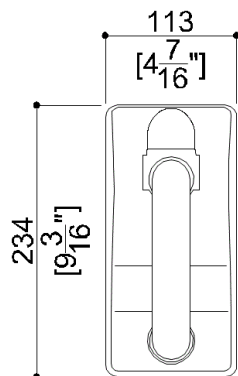







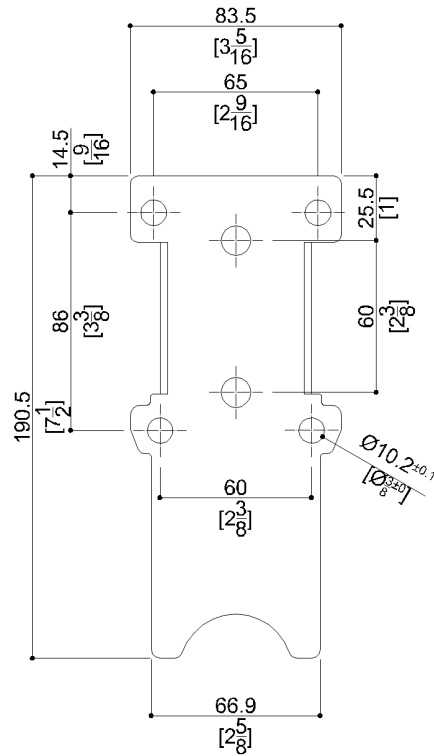

**G41JCS09xx**    *Series*   Tubocolor

**Y88JKS77**

AISI304 stainless steel fixing plate



**Available Finishes (xx)**

<b>B1</b> 	Blue	<b>D1</b> 	Black	<b>D2</b> 	Greystone
<b>D4</b> 	Dark Gray	<b>I2</b> 	Biscuit	<b>P4</b> 	Prune
<b>R7</b> 	Ruby red	<b>W1</b> 	White	<b>Y3</b> 	Light Yellow

## Materials and finishes

Steel	Rough
Polyamide	Polished
Vinyl	Polished
Stainless Steel	Rough

## Installation

Ponte Giulio suggests the product must be installed by a professional operator, wich is capable to verify the characteristics of the support to which the item must be installed.

### Load Capacity

Vertical	331 lbs.	Horizontal	88 lbs.
----------	----------	------------	---------

### Warning

Before installation and use, read the installation and use instructions in their entirety. If questions arise please contact Ponte Giulio company.

## Cleaning

The device is not affected by the room's temperature, though it must NOT be installed in environments subject to temperatures below 4°C or above 40°C.

Do not install in saunas. Not comply with the indicated temperatures may damage the plastic coating of the device.

## Warranty

Please visit [www.pontegiulio.com](http://www.pontegiulio.com) for complete warranty details.