

G25JBL19XX Series Pro Series

24"x12" antimicrobial vinyl coated L-shape grab bar, left orientation. No maintenance 3mm thick antimicrobial vinyl coating. Concealed ABS 4-hole flange plate.

Mounting hardware supplied for wood stud installation.

Product Data

Overall Dimensions (Inch.)	15-3/16x2-3/4x27-3/16
Net Weight (lbs.)	3.97

Installation Hardware Details

Stainless steel screw	TSP 5x60 Inox
-----------------------	---------------

Packaging Details

Package	LDPE bag in cardboard box
Package dimensions (Inch.)	20-1/2 x 7-7/8 x 4-5/16
Weight with Packaging (lbs.)	4.52

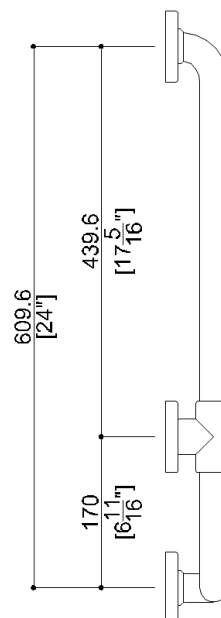
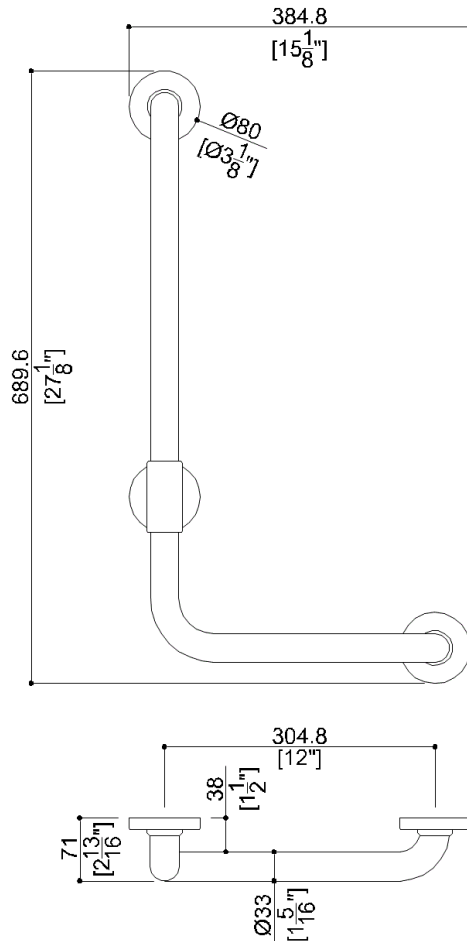

G25JBL19XX Series Pro Series

Y87JKS01

Fixing plate

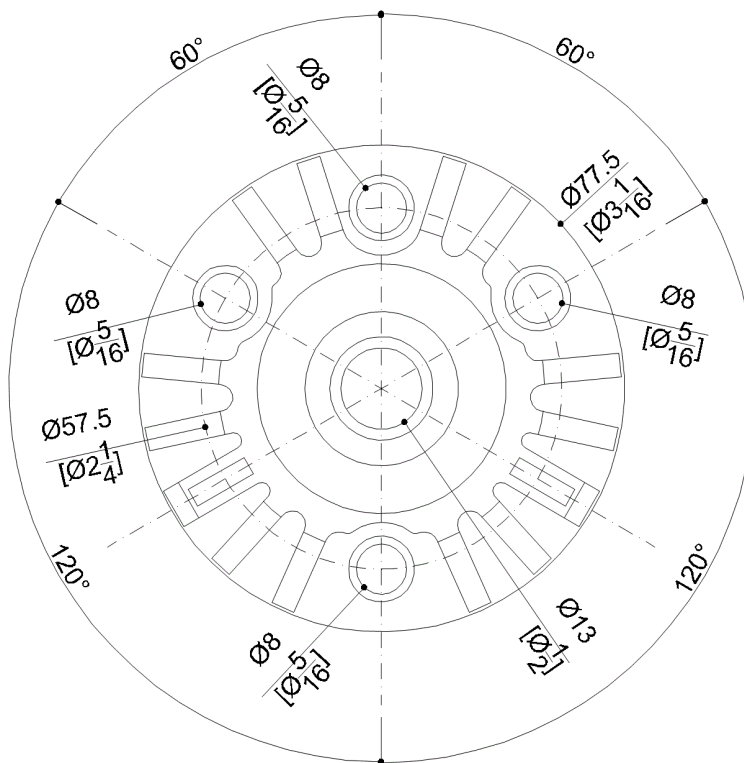

Available Finishes (xx)

D1	Black	D2	Greystone	I1	Ivory
I2	Biscuit	W1	White		

Materials and finishes

Steel	Galvanised
Polyamide	Polished
Vinyl	Polished

Load Capacity

Vertical	450 lbs.
----------	----------

Warning

Before installation and use, read the installation and use instructions in their entirety. If questions arise please contact Ponte Giulio company.

Cleaning

The device is not affected by the room's temperature, though it must NOT be installed in environments subject to temperatures below 4°C or above 40°C.

Do not install in saunas. Not comply with the indicated temperatures may damage the plastic coating of the device.

Warranty

Please visit www.pontegiulio.com for complete warranty details.