

## G25JAS04XX Series Pro Series

24" Antimicrobial vinyl coated grab bar. No maintenance  
3mm thick antimicrobial vinyl coating. Concealed ABS 4-  
hole flange plate.

Mounting hardware supplied for wood stud installation.

### Product Data

Overall Dimensions (Inch.)	27-3/16x2-3/4x3-3/16
Net Weight (lbs.)	3.26

### Installation Hardware Details

Stainless steel screw	TSP 5x60 Inox
-----------------------	---------------

### Packaging Details

Package	LDPE bag in cardboard box
Package dimensions (Inch.)	27-13/16 x 3-11/16 x 3-11/16
Weight with Packaging (lbs.)	3.53

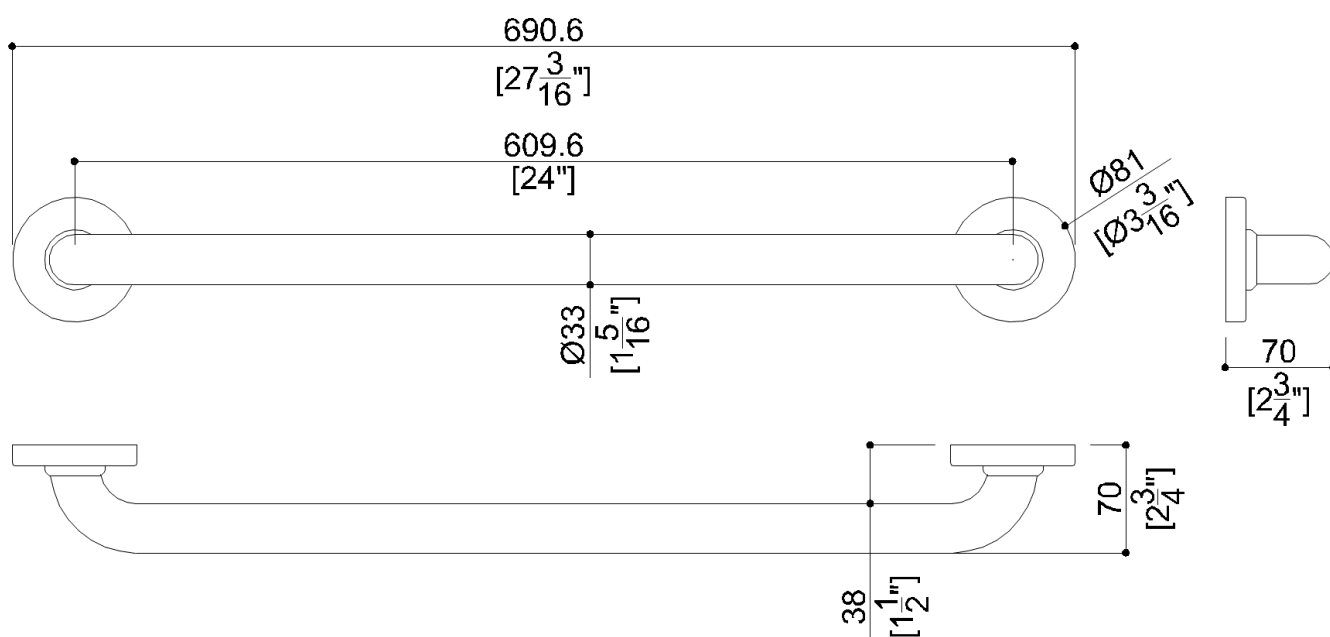

**G25JAS04XX**    Series   Pro Series

Y87JKS01

Fixing plate

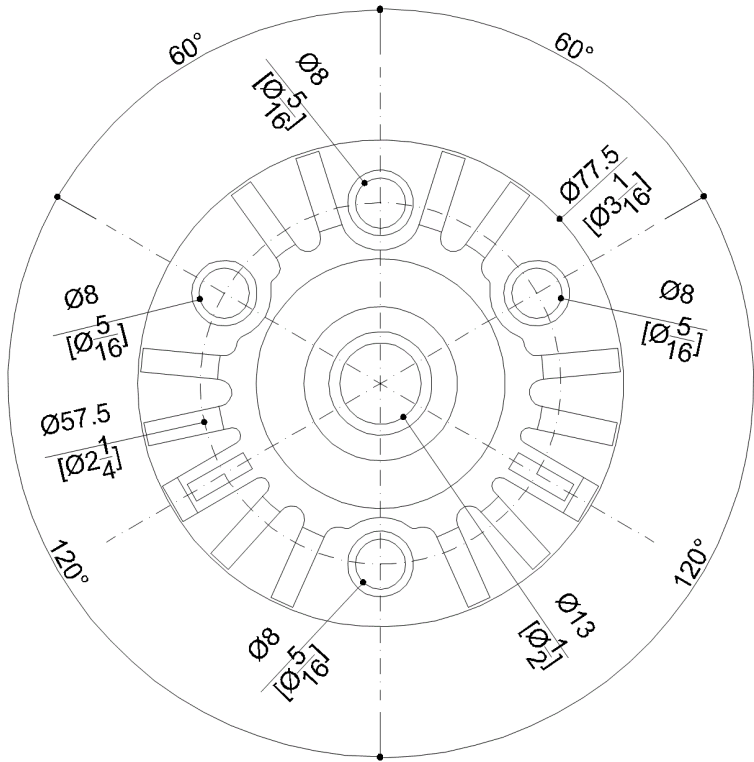

**Available Finishes (xx)**

<b>D1</b>	Black	<b>D2</b>	Greystone	<b>I1</b>	Ivory
<b>I2</b>	Biscuit	<b>W1</b>	White		

**Materials and finishes**

Steel	Rough
Vinyl	Polished
Polyamide	Polished

**Load Capacity**

Vertical	331 lbs.
----------	----------

**Warning**

Before installation and use, read the installation and use instructions in their entirety. If questions arise please contact Ponte Giulio company.

**Cleaning**

The device is not affected by the room's temperature, though it must NOT be installed in environments subject to temperatures below 4°C or above 40°C.  
Do not install in saunas. Not comply with the indicated temperatures may damage the plastic coating of the device.

**Warranty**

Please visit [www.pontegiulio.com](http://www.pontegiulio.com) for complete warranty details.