

## G18JCS09XX Series HUG

33" folding grab bar, removable, stainless steel, ABS and aluminum flange cover,

Optional accessories for this product: F18AGS01, F18JMS01, F18JIS01

### Product Data

Overall Dimensions (Inch.)	3-15/16x33-7/16x4-3/4
Net Weight (lbs.)	7.5

### Packaging Details

Package	LDPE bag in cardboard box
Package dimensions (Inch.)	35 x 5-11/16 x 4-5/16
Weight with Packaging (lbs.)	8.22

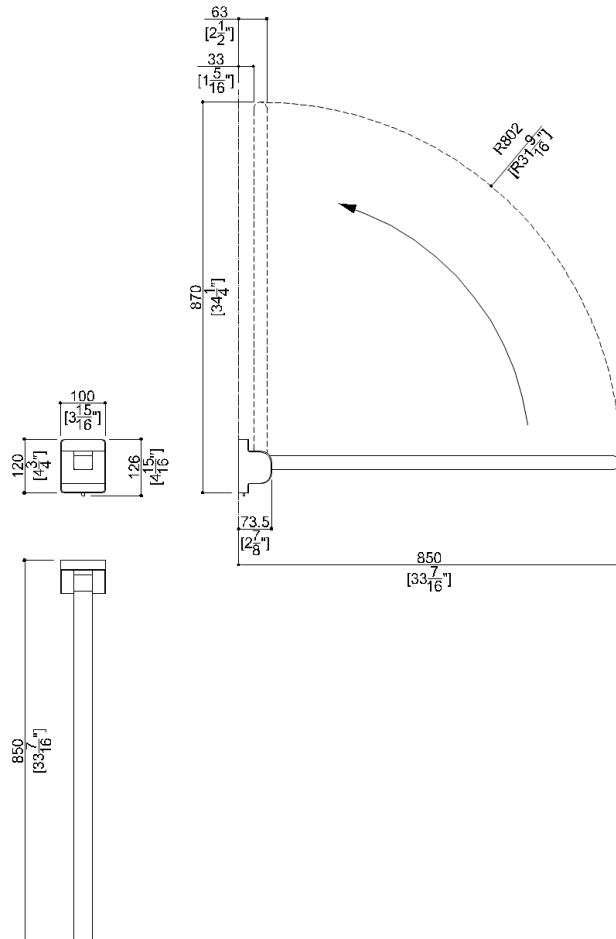

## G18JCS09XX Series HUG





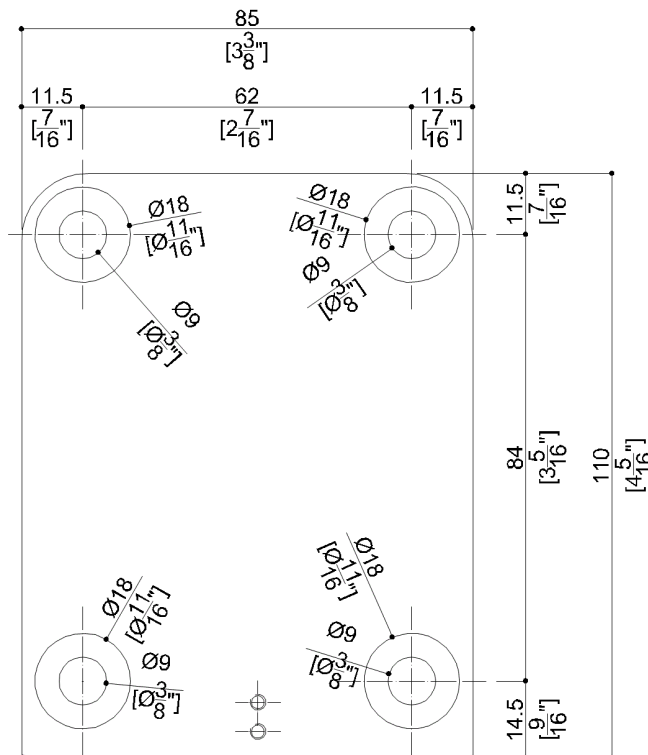



Y88JKS82

Aluminum fixing plate



### Available Finishes (xx)

#### Arm finish

<b>C1</b> 	Chrome	<b>DD</b> 	Graphite	<b>DM</b> 	Black Matte
<b>E4</b> 	Satin Pink Gold	<b>E5</b> 	Satin Black Nickel	<b>E6</b> 	Satin Dark Bronze
<b>PB</b> 	Coral	<b>WE</b> 	Signal White		

#### Flange cover finish

<b>C1</b> 	Chrome	<b>D4</b> 	Dark Gray	<b>DM</b> 	Black Matte
<b>E4</b> 	Satin Pink Gold	<b>E5</b> 	Satin Black Nickel	<b>E6</b> 	Satin Dark Bronze
<b>E6</b> 	Coral	<b>WE</b> 	Signal White		

### Materials and finishes

Aluminium	Matt
Aluminium	Polished
ABS	Matt

### Load Capacity

Vertical	331 lbs.	Horizontal	220 lbs.
----------	----------	------------	----------

### Warning

Before installation and use, read the installation and use instructions in their entirety. If questions arise please contact Ponte Giulio company.

### Cleaning

The device is not affected by the room's temperature, though it must NOT be installed in environments subject to temperatures below 4°C or above 40°C.

Do not install in saunas. Not comply with the indicated temperatures may damage the plastic coating of the device.

### Warranty

Please visit [www.pontegiulio.com](http://www.pontegiulio.com) for complete warranty details.