

G13UAS03XX Series HUG

18" real wood grab bar, ash wood, polished stainless steel ends and peg mounting flange

Mounting hardware supplied for wood stud installation.

Product Data

Overall Dimensions (Inch.)	22-3/16x2-3/4x1-1/4
Net Weight (lbs.)	1.32

Installation Hardware Details

Stainless steel screw	TSP 5x60 Inox
-----------------------	---------------

Packaging Details

Package	LDPE bag in cardboard box
Package dimensions (Inch.)	27-5/8 x 3-1/2 x 3-11/16
Weight with Packaging (lbs.)	1.98

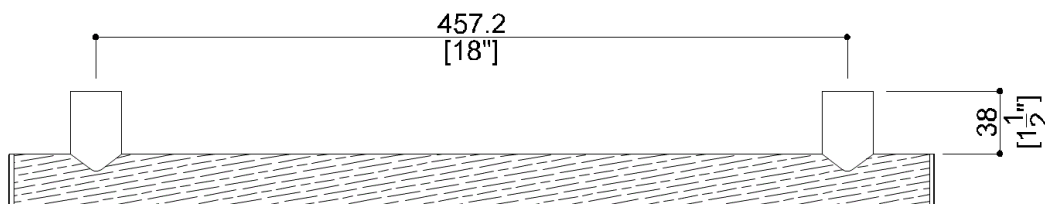
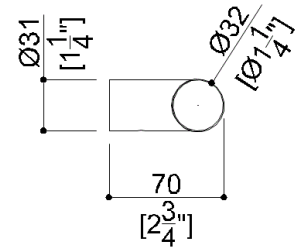
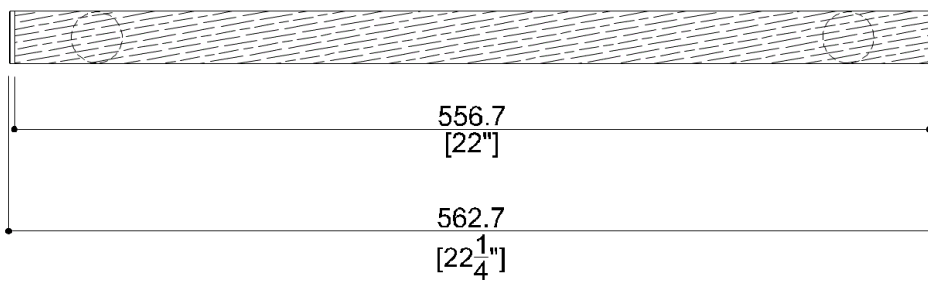

G13UAS03XX Series HUG

Available Finishes (xx)

L7
 Cherrywood

Materials and finishes

Aluminium	N/A.
Ash wood	Matt

Load Capacity

Vertical 331 lbs.

Warning

Before installation and use, read the installation and use instructions in their entirety. If questions arise please contact Ponte Giulio company.

Cleaning

The device is not affected by the room's temperature, though it must NOT be installed in environments subject to temperatures below 4°C or above 40°C.

Do not install in saunas. Not comply with the indicated temperatures may damage the plastic coating of the device.

Warranty

Please visit www.pontegiulio.com for complete warranty details.