

G12JDS05XX Series HUG

Folding seat in polyurethane with internal structure in stainless steel and fixing flange in aluminium

Product Data

| | |
|----------------------------|------------------------|
| Overall Dimensions (Inch.) | 16-9/16x18-1/8x3-15/16 |
| Net Weight (lbs.) | 11.68 |

Installation Hardware Details

Packaging Details

| | |
|------------------------------|---------------------------|
| Package | LDPE bag in cardboard box |
| Package dimensions (Inch.) | 17-5/16 x 5-1/2 x 19-1/8 |
| Weight with Packaging (lbs.) | 13.27 |

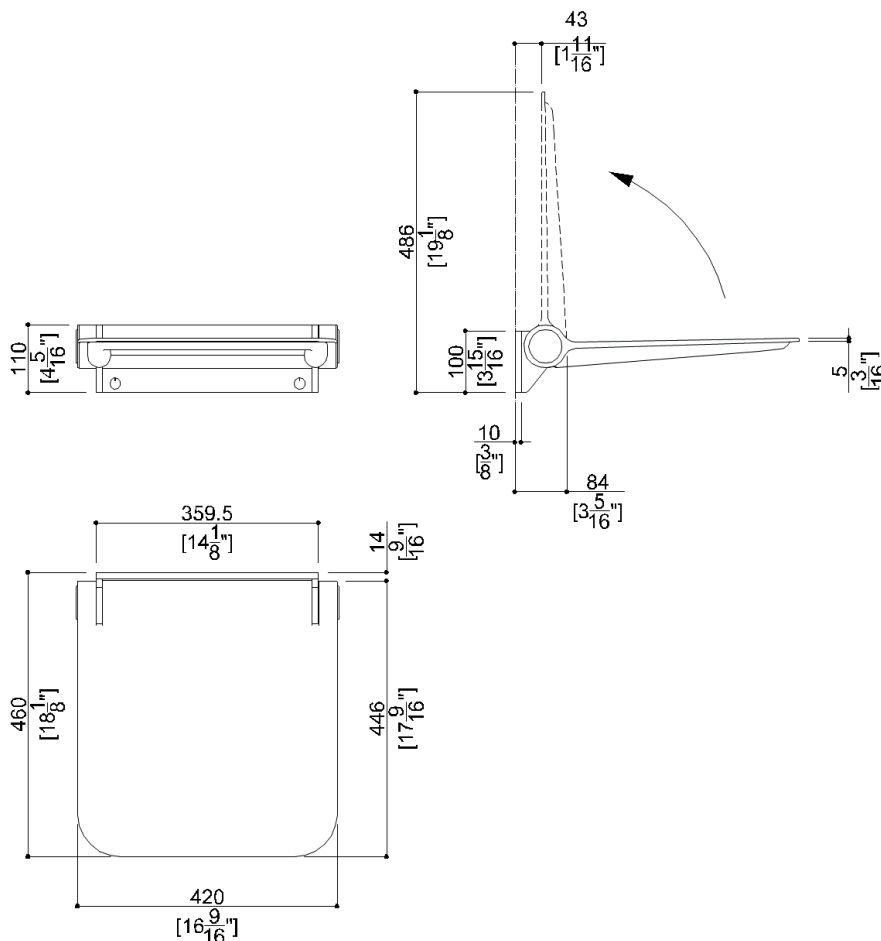

G12JDS05XX Series HUG

Y88JKS81

Aluminum fixing plate

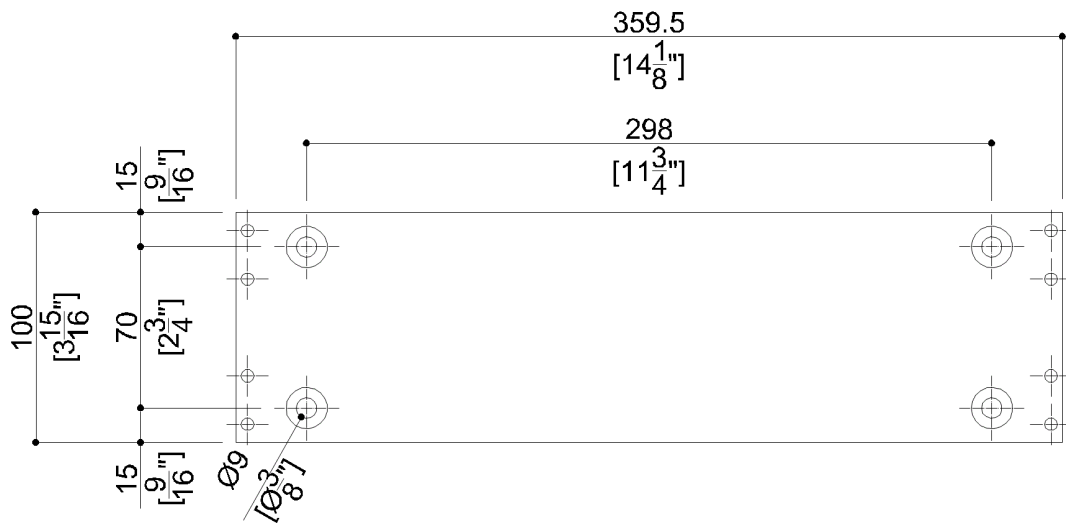

Available Finishes (xx)

Seat

| | | | | | |
|----|--------------|----|-------------|----|-------|
| DD | Graphite | DM | Black Matte | PB | Coral |
| WE | Signal White | | | | |

Plate

| | |
|----|-------|
| N1 | Satin |
|----|-------|

Materials and finishes

| | |
|--------------------------|----------|
| Polyurethane (PU or PUR) | Matt |
| Stainless Steel | Rough |
| Aluminium | Polished |

Load Capacity

| | |
|----------|----------|
| Vertical | 450 lbs. |
|----------|----------|

Warning

Before installation and use, read the installation and use instructions in their entirety. If questions arise please contact Ponte Giulio company.

Cleaning

The device is not affected by the room's temperature, though it must NOT be installed in environments subject to temperatures below 4°C or above 40°C.
Do not install in saunas. Not comply with the indicated temperatures may damage the plastic coating of the device.

Warranty

Please visit www.pontegiulio.com for complete warranty details.