

## F18JIS02XX Series HUG

Wall plate cover for removable folding seat

### Product Data

Overall Dimensions (Inch.)	12-13/16x0-13/16x4-3/16
Net Weight (lbs.)	1.32

### Packaging Details

Package	Polyethylene package
---------	----------------------

Package dimensions (Inch.)
Weight with Packaging (lbs.)

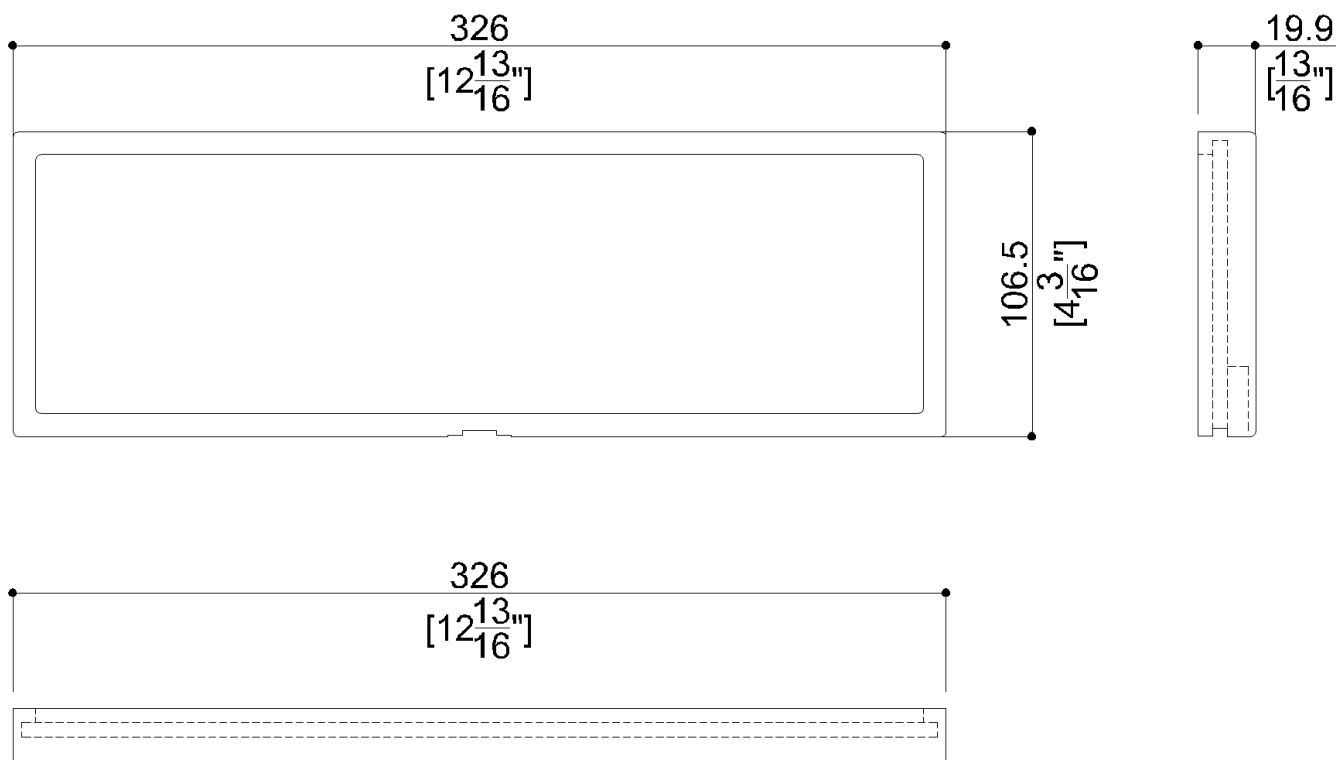

## F18JIS02XX Series HUG

### Available Finishes (xx)

DD	PB	WE
		
Graphite	Coral	Signal White

### Materials and finishes

Vinyl	Matt
-------	------

### Warning

Before installation and use, read the installation and use instructions in their entirety. If questions arise please contact Ponte Giulio company.

### Cleaning

The device is not affected by the room's temperature, though it must NOT be installed in environments subject to temperatures below 4°C or above 40°C.

Do not install in saunas. Not comply with the indicated temperatures may damage the plastic coating of the device.

### Warranty

Please visit [www.pontegiulio.com](http://www.pontegiulio.com) for complete warranty details.