

**B46CMM20xx**    *Series* 45gradi

Acrylic stone sink with built in hand pull / towel holder.  
Elbow rests.

Mounting hardware not supplied. Support brackets that attach to sink:  
B41DCS13 (requires 2).

### Product Data

Overall Dimensions (Inch.)	27-9/16x22-1/16x5-3/16
Net Weight (lbs.)	30.86

### Packaging Details

Package	Wooden crate package
Package dimensions (Inch.)	30-11/16 x 25-3/16 x 7-1/2
Weight with Packaging (lbs.)	51.81

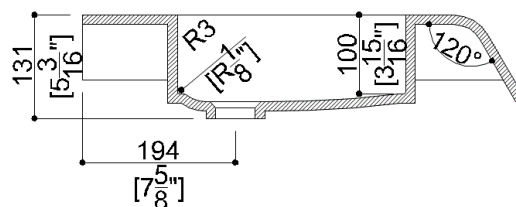
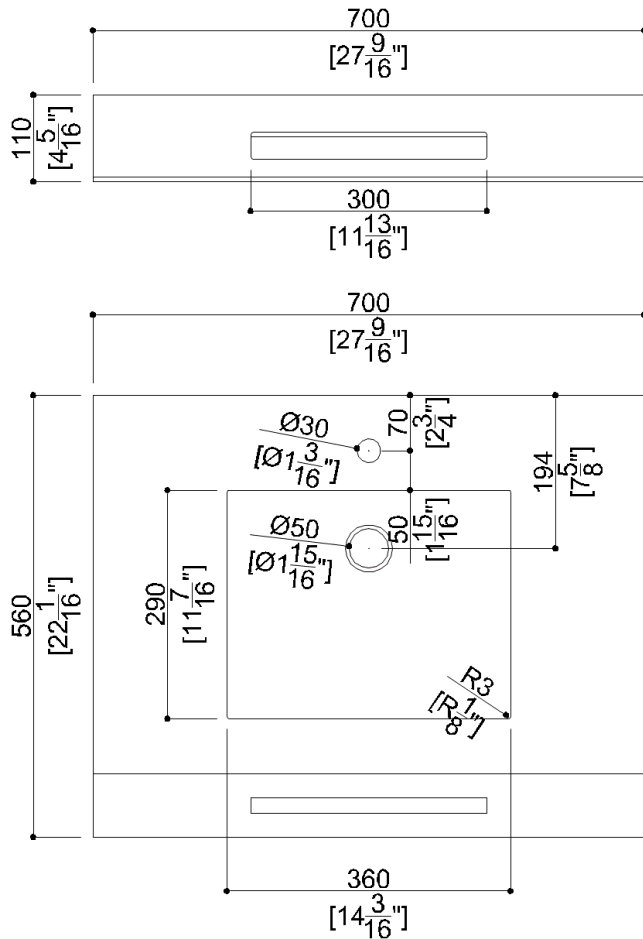

## B46CMM20XX Series 45gradi

### Available Finishes (xx)

W3  
Alpine white

### Materials and finishes

Acrylic stone	Matt
Steel	Polished

### Load Capacity

Vertical 331 lbs.

### Warning

Before installation and use, read the installation and use instructions in their entirety. If questions arise please contact Ponte Giulio company.

### Cleaning

The device is not affected by the room's temperature, though it must NOT be installed in environments subject to temperatures below 4°C or above 40°C.

Do not install in saunas. Not comply with the indicated temperatures may damage the plastic coating of the device.

### Warranty

Please visit [www.pontegiulio.com](http://www.pontegiulio.com) for complete warranty details.