

B43CMS01XX *Series* 470

Italian designer sink. Porcelain.

Support bracket that attach to sink Mounting hardware not supplied. , sold separately: B41DCS01. Wall-mount hardware Mounting hardware not supplied. .

Product Data

Overall Dimensions (Inch.)	27-9/16x22-7/16x5-7/8
Net Weight (lbs.)	41.89

Packaging Details

Package	Cardboard package
Package dimensions (Inch.)	34-5/8 x 9-13/16 x 23-5/8
Weight with Packaging (lbs.)	44.09

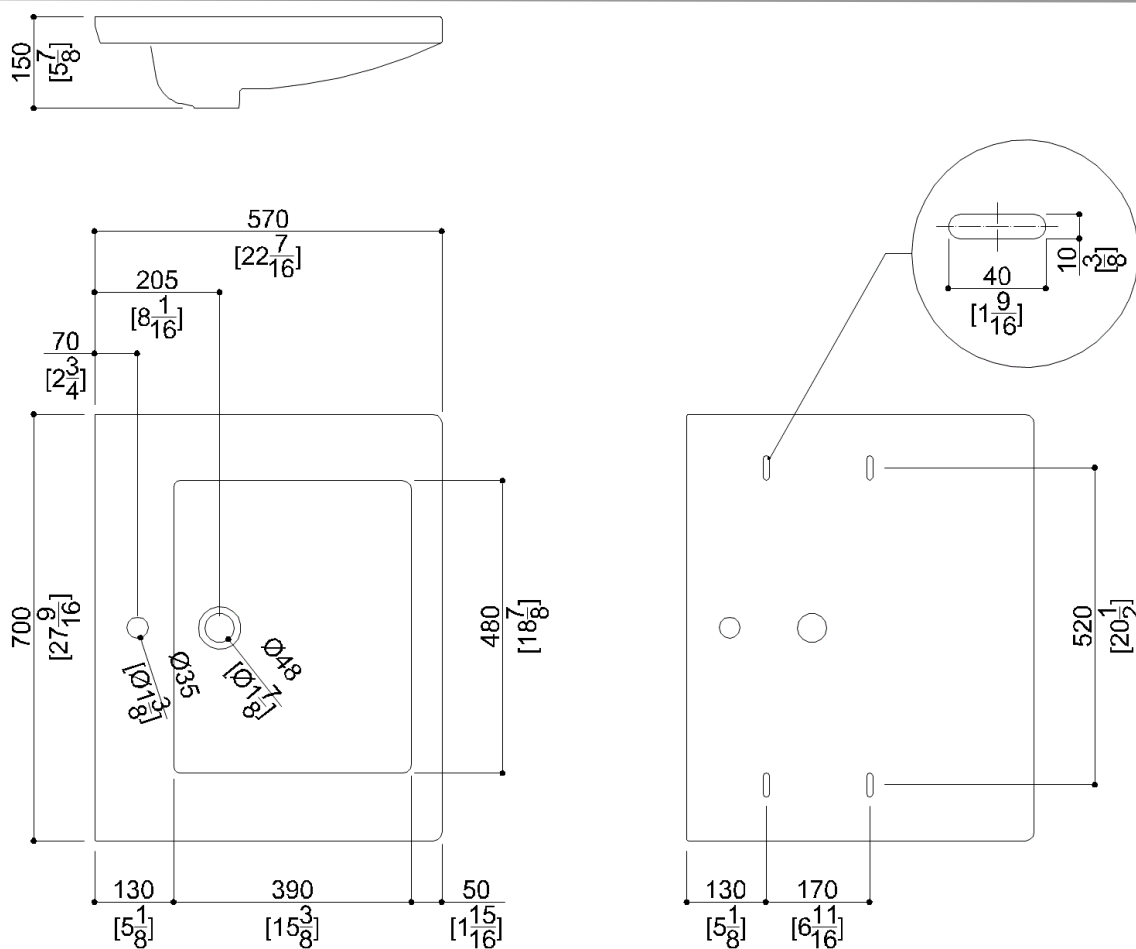

B43CMS01XX Series 470

Available Finishes (xx)

DA	WB
	
Black Lavic	White Ceramic

Materials and finishes

Porcelain	Polished
-----------	----------

Load Capacity

Vertical	331 lbs.
----------	----------

Warning

Before installation and use, read the installation and use instructions in their entirety. If questions arise please contact Ponte Giulio company.

Cleaning

The device is not affected by the room's temperature, though it must NOT be installed in environments subject to temperatures below 4°C or above 40°C.

Do not install in saunas. Not comply with the indicated temperatures may damage the plastic coating of the device.

Warranty

Please visit www.pontegiulio.com for complete warranty details.