

# H51HAS07XX Series Standard

Syphon, chromed

**Product Data**

Overall Dimensions (Inch.)	2-3/16x12-5/16x11-7/8
Net Weight (lbs.)	0.44

**Packaging Details**

Package	Polyethylene package
Package dimensions (Inch.)	2-3/8 x 12-5/8 x 12-3/16
Weight with Packaging (lbs.)	0.49

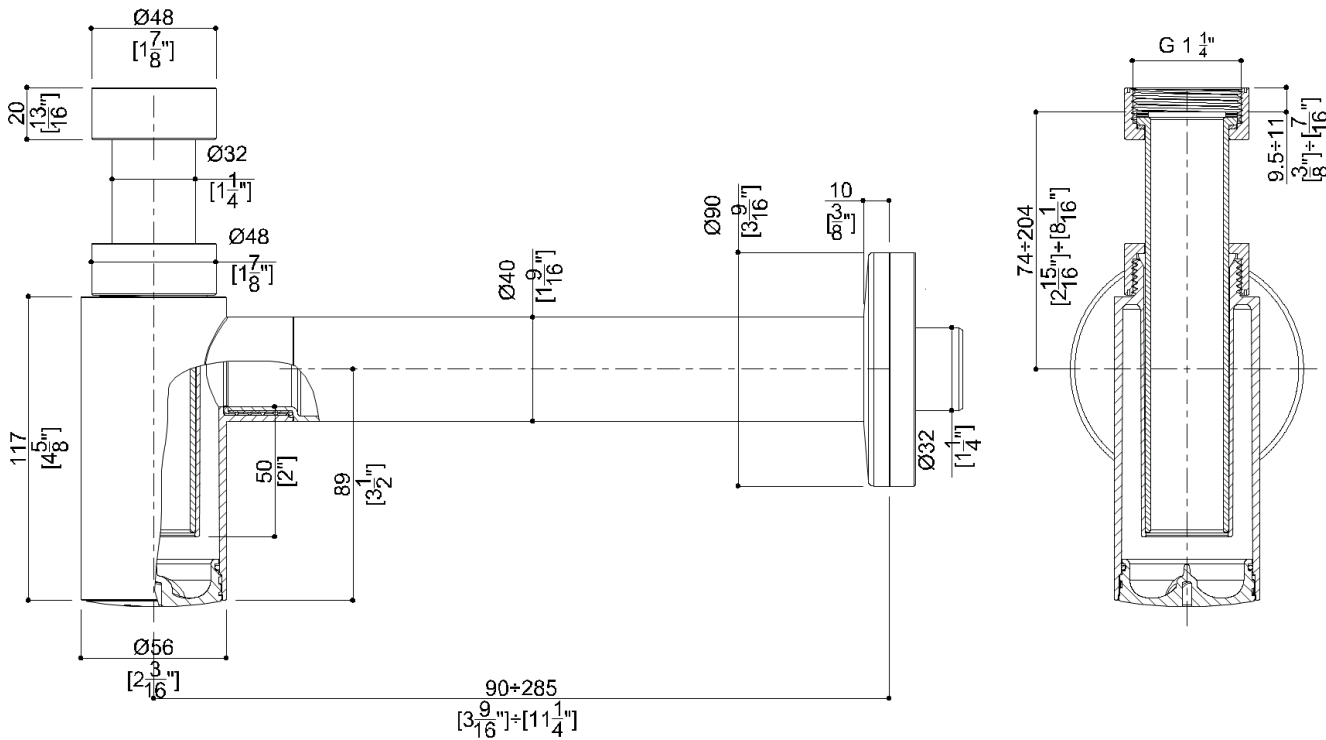

## H51HAS07XX *Series* Standard

### Available Finishes (xx)

---

C1  
 Chrome

### Materials and finishes

---

ABS Chrome

---

### Warning

Before installation and use, read the installation and use instructions in their entirety. If questions arise please contact Ponte Giulio company.

### Cleaning

---

The device is not affected by the room's temperature, though it must NOT be installed in environments subject to temperatures below 4°C or above 40°C.

Do not install in saunas. Not comply with the indicated temperatures may damage the plastic coating of the device.

### Warranty

---

Please visit [www.pontegiulio.com](http://www.pontegiulio.com) for complete warranty details.