

Y87JOS04XX *Range Standard*

The ergonomic shower head holder, adjustable using only one hand, is expandable and fit for shower bar and handrails, easy upper and lower stepless adjustment. A choice of colours are available.

Physical data

Dimensions (mm.)	95x116x163
Weight (kg.)	0,160





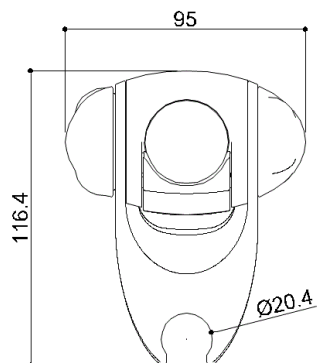
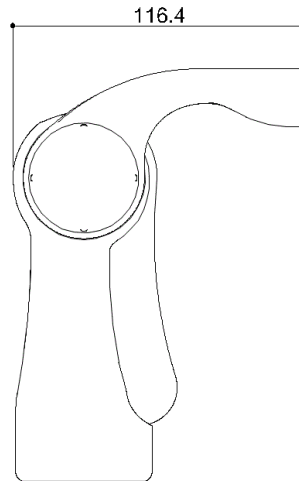
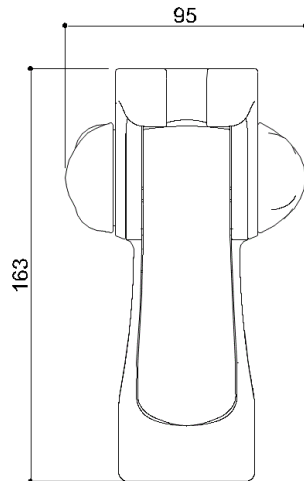











Delivery methods

Package	Polyethylene package
Package dimensions (mm.)	205x120x85
Weight with Packaging (kg.)	0,26



Y87JOS04XX *Range Standard*

Available colors

B1  Blue	B2  Light blue	C1  Chrome
D1  Black	D2  Greystone	D4  Dark Grey
G1  Green	G2  Light Green	I1  Ivory
I2  Biscuit	P4  Prune	R1  Vivid Red
R7  Ruby red	W1  White	Y1  Yellow Sun
Y3  Light yellow		

Materials and finishes

ABS	Polished
-----	----------

Safety tips

Before installing and using the device, read the instructions for use and especially the safety warnings carefully and follow them. If in doubt, contact the company before using the device.

Information on use

The device is not affected by the room's temperature, though it must NOT be installed in environments subject to temperatures below 4°C or above 40°C.

Do not install in saunas. Not comply with the indicated temperatures may damage the plastic coating of the device.

Warranty

If this product fails due to a defect in material or workmanship during the time of periods listed below for each product, Ponte Giulio will replace or repair it free of charge. .

Warranty 2 YEARS