



Code
G01JDSxx07

Product series
Seat and Benches

Product lines
Tubicolor

Model

Description
Folding seat 15" 1/2 x 13

Standard / Guide line
UNI

Reliefs

Other characteristics

Colour	Technical
B1	Blue
B2	Light Blue
D1	Black
D2	Grey
G1	Green
G2	Light
I1	Ivory
I2	Biscuit
R1	Red
W1	White
Y1	Yellow

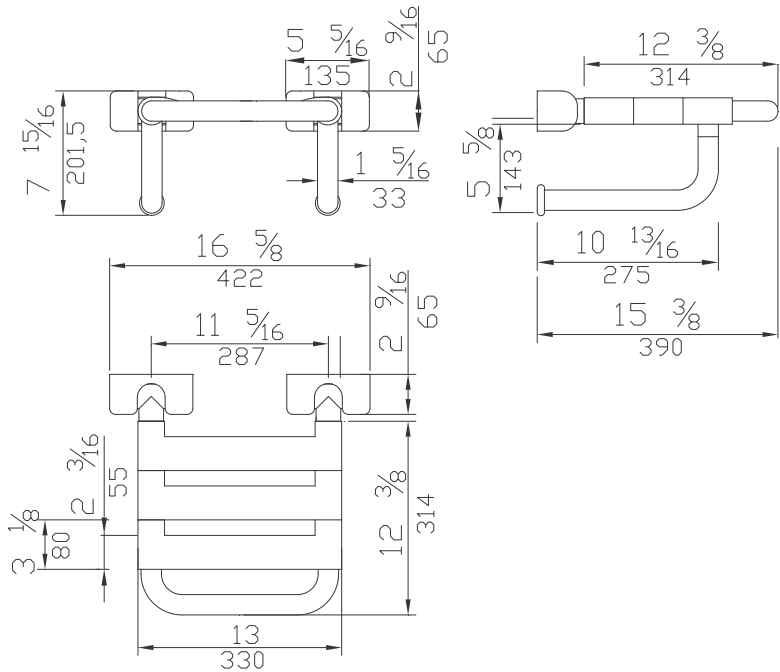

Mechanical Data

Height [in.]	7 15/16	Width [in.]	16 5/8	Depth [in.]	15 3/8
Diameter [in.]	1 5/16	Net Weight [lb.]	11,47lb	Side/Toward	Not Applicable

Fasteners

Included with the product

Use modality

Use Wall installation
 Cleaning Use normal detergents or disinfectants that are non abrasive and contain no solvents

Storing Store in closed and dry place

Vertical load [lb.] 450lb Horizontal load [lb.]

Packaging information

Package Nylon bag in cardboard packaging
 Package external dimensions [WxDxH] [in.] 15 15/16x15 3/8x8 7/8 Gross Weight [lb.] 13

Certifications

Specification	Norm	Agency
Technical aids	EN 12182:1999	TÜV Product Service GMBH
Biocompatibility	DIN EN ISO 10993	Bioserv
CE	MDD 93/42	Ponte Giulio declaration [Italy]
Electrical insulation	EN 60664-1:2007	TÜV

Product composition

Part Description	Material	Finish
Structure, 3/4" hose	Steel [FE360]	Galvanised
Coating, 2.5 mm Ø33 extrusion	Vinyl 78ShA	Glossy
Plate, 3 mm "C" slab 94x60x60 mm	Steel [Aisi 304]	Tumbled
Plate cover, 135x67x64 mm	Polyamide 6 [PA6]	Glossy
Plate holder, 130x17x60 mm	Polyamide 6 [PA6]	Rough finish
Seat, stave	Polyamide 6 [PA6]	Glossy